



PWCキット-ヒートグリップGTI、GTR、ウェイク MY20以上

印刷可能バージョン

この記事の評価する

(平均評価: 評価なし)

言語 英語 ▼

プロパティを表示

製品:	Sea-Doo_watercraft
プロジェクト番号:	487803271_rev3
インストラクションシートP/N:	487803271
改訂番号:	3
改訂日:	2021年2月
対象アイテム:	加熱グリップ-GTI、GTR、WakeMY20以上

重要な情報: ハンドルバースイッチカバーは、加熱されたグリップワイヤーのためのスペースを確保するためにノッチを付ける必要があります。この手順を実行しないと、早期の摩耗、水の侵入、および製品の故障を引き起こす可能性があります。

このドキュメントでは、次の記号を使用できます。

⚠ 警告

回避しないと、死亡または重傷を負う可能性のある危険な状況を示します。

⚠ 注意: 回避しないと、軽傷または中程度の傷害を引き起こす可能性のある危険な状況を示します。

通知 従わないと、車両のコンポーネントやその他の資産に重大な損傷を与える可能性のある指示を示します。

⚠ 警告

- このキットは、特定の該当するモデル専用設計されています（認定BRPディーラーがモデルを確認します）。販売されたユニット以外のユニットにはお勧めしません。
- 分解/組み立ての際にロック装置（ロックタブ、セルフロックファスナーなど）の取り外しが必要な場合は、必ず新しいものと交換してください。
- トルクレンチの締め付け仕様を厳守する必要があります。
- 特に指定のない限り、車両で操作を行うときはエンジンをオフにする必要があります。
- キットのインストールにテンプレートが必要な場合は、テンプレートが縮尺どおりであることを確認してください。
- 電動工具を使用するときは、常に目の保護具と適切な手袋を着用してください。
- 一部のコンポーネントはHOTである可能性があります。作業を行う前に、必ずエンジンが冷えるのを待ってください。



警告

この取扱説明書には、エンドユーザー専用の重要な安全情報や操作説明書が含まれている場合があります。キットの部品番号と、このキットに含まれている取扱説明書を必ずお客様に提供してください。お客様がアクセサリを適切に使用するために必要なすべての情報にアクセスできることを確認します。

注：特に指定がない場合は、次の表の締め付けトルクを使用してください。

	グレード			
	5.8	8.8	10.9	12.9
M4	1.8±0.2N•m (16±2lbf•in)	2.8±0.2N•m (25±2lbf•in)	3.8±0.2N•m (34±2lbf•in)	4.5 ± 0.5 N•m (40 ± 4 lbf•in)
M5	3.3 ± 0.2 N•m (29 ± 2 lbf•in)	5 ± 0.5 N•m (44 ± 4 lbf•in)	7.8 ± 0.7 N•m (69 ± 6 lbf•in)	9 ± 1 N•m (80 ± 9 lbf•in)
M6	7.5 ± 1 N•m (66 ± 9 lbf•in)	10 ± 2 N•m (89 ± 18 lbf•in)	12.8 ± 2.2 N•m (113 ± 19 lbf•in)	16 ± 2 N•m (142 ± 18 lbf•in)
M8	15.3 ± 1.7 N•m (135 ± 15 lbf•in)	24.5 ± 3.5 N•m (18 ± 3 lbf•ft)	31.5 ± 3.5 N•m (23 ± 3 lbf•ft)	40 ± 5 N•m (30 ± 4 lbf•ft)
M10	29 ± 3 N•m (21 ± 2 lbf•ft)	48 ± 6 N•m (35 ± 4 lbf•ft)	61 ± 9 N•m (45 ± 7 lbf•ft)	73 ± 7 N•m (54 ± 5 lbf•ft)
M12	52 ± 6 N•m (38 ± 4 lbf•ft)	85 ± 10 N•m (63 ± 7 lbf•ft)	105 ± 15 N•m (77 ± 11 lbf•ft)	128 ± 17 N•m (94 ± 13 lbf•ft)
M14	85 ± 10 N•m (63 ± 7 lbf•ft)	135 ± 15 N•m (100 ± 11 lbf•ft)	170 ± 20 N•m (125 ± 15 lbf•ft)	200 ± 25 N•m (148 ± 18 lbf•ft)
M16	126 ± 14 N•m (93 ± 10 lbf•ft)	205 ± 25 N•m (151 ± 18 lbf•ft)	255 ± 30 N•m (188 ± 22 lbf•ft)	305 ± 35 N•m (225 ± 26 lbf•ft)
M18	170 ± 20 N•m (125 ± 15 lbf•ft)	273 ± 32 N•m (201 ± 24 lbf•ft)	330 ± 25 N•m (243 ± 18 lbf•ft)	413 ± 47 N•m

(305

± 35
lbf•ft)

The illustrations in this document show typical construction of the different assemblies and may not reproduce the full detail or exact shape of the parts; however, they represent parts that have the same or similar function.

Installation time is approximately 1.0 hour.

PARTS TO BE INSTALLED

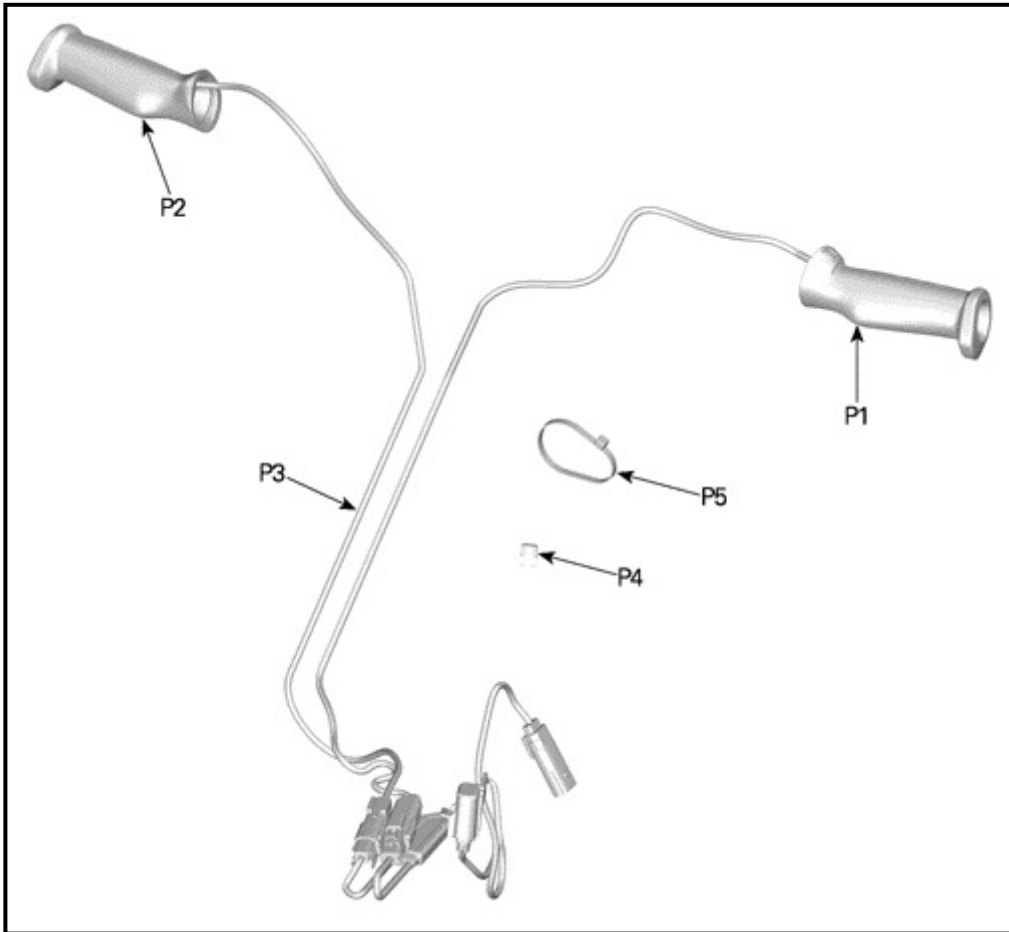

ITEM	DESCRIPTION	Part number	QTY
P1	LH Heated handlebar grip	Not available seperately	1
P2	RH Heated handlebar grip	Not available seperately	1
P3	Heated grip wiring harness	Not available seperately	1
P4	5 AMP Little fuse	710000742	1
P5	142mm Locking tie	293750002	10

INSTRUCTIONS

Vehicle Preparation

NOTICE Always disconnect battery before doing any electrical modifications. Do not place tools on battery. Proceed exactly in this specific order:

- Disconnect **BLACK** cable (-) first.
- Disconnect **RED** cable (+) after.
- **Secure battery by covering poles with isolating material.**

Remove the following components.

1. Remove the following components.

- Seat
- Lateral Trim Panel
- Gauge support
- Mirror support

2. Remove the following components, refer to *STEERING* subsection of the appropriate shop manual.

- Steering pad
- Steering cover
- Right and left switch covers
- Both grips and keep screws and caps
- Disconnect D.E.S.S. connector.

Removing the Seat

To remove the seat, push on the two release buttons and lift the back end of the rear seat.

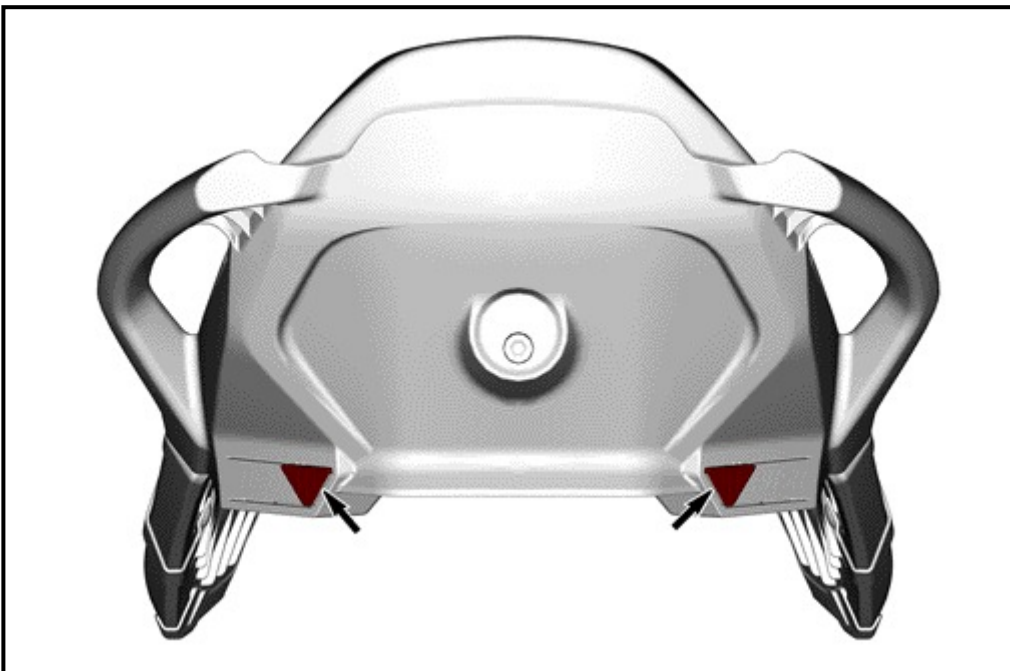

RELEASE BUTTONS

Then pull the latch handle up and remove the front seat from the watercraft.

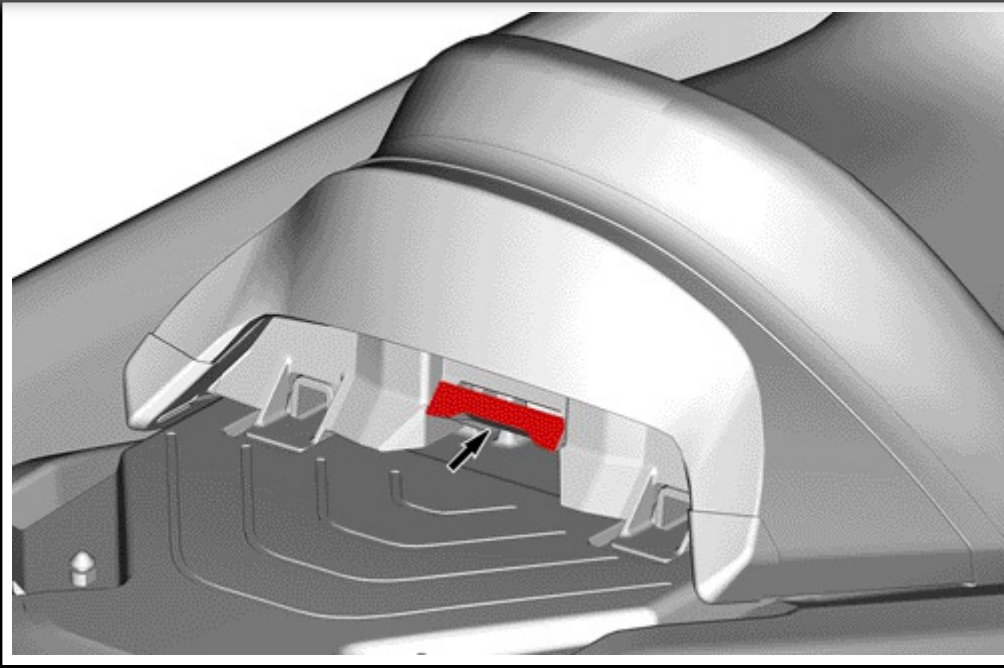

LATCH HANDLE

Removing the Gauge Support

1. Open storage compartment cover.
2. Remove following retaining screws and then unlock the tabs.

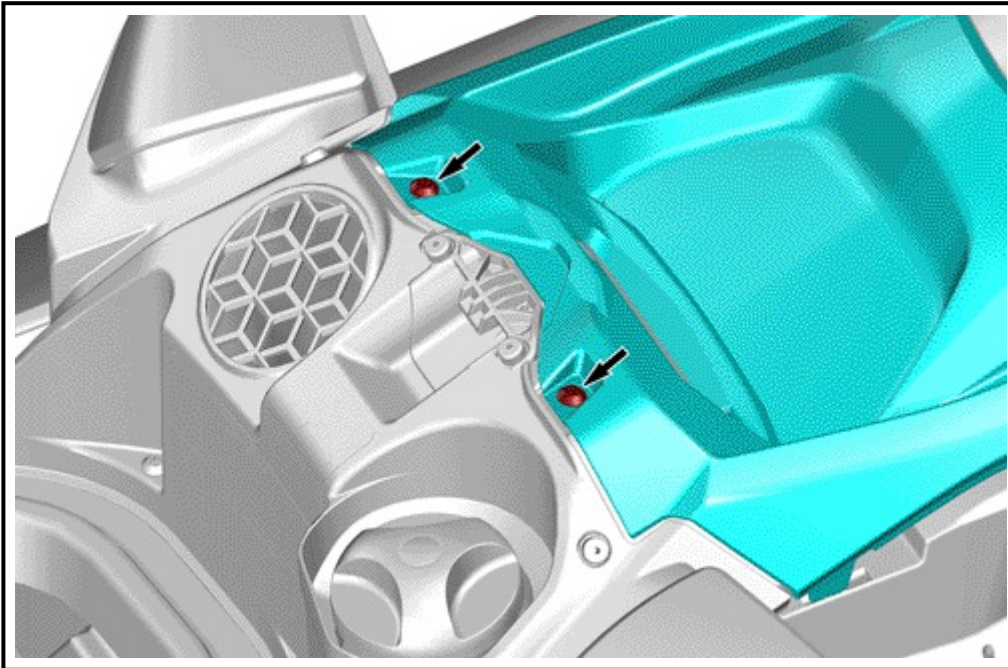

3. Remove gauge trim from mirror support.

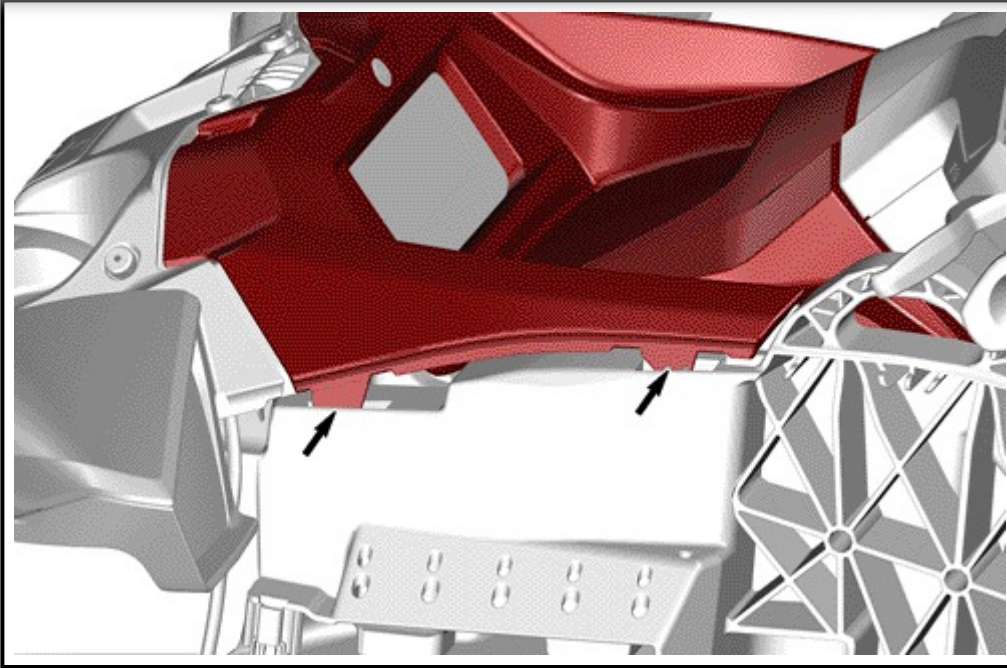

Removing the Mirror Support

1. Remove the following screws.

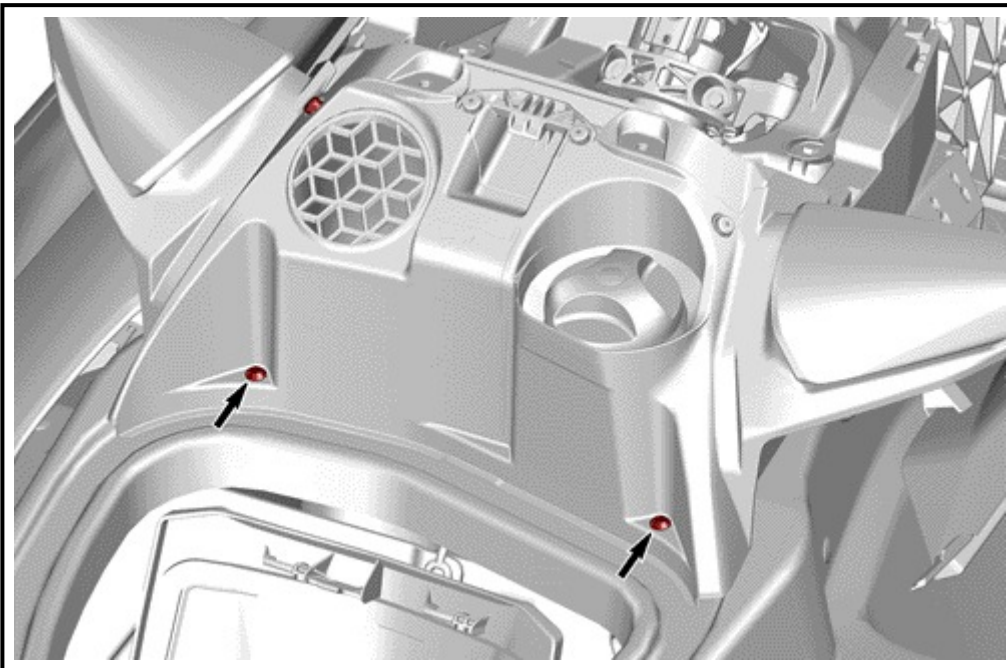

2. Remove mirror support by pulling it upwards.

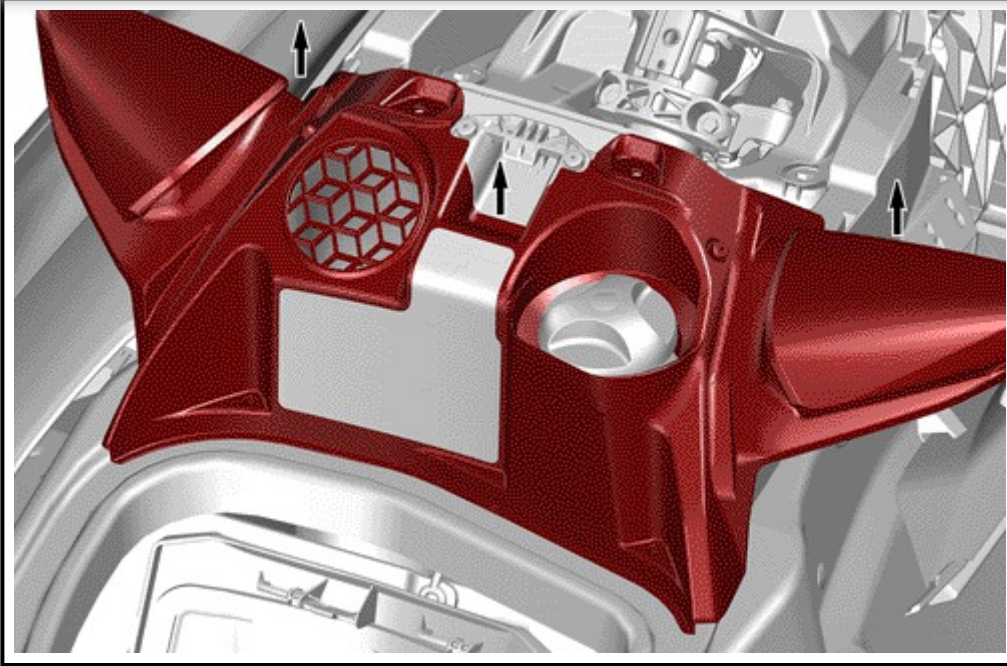

Removing the Lateral Trim Panel

1. Remove both left lateral trim panels at the same time.
 - 1.1 Remove following fastener.

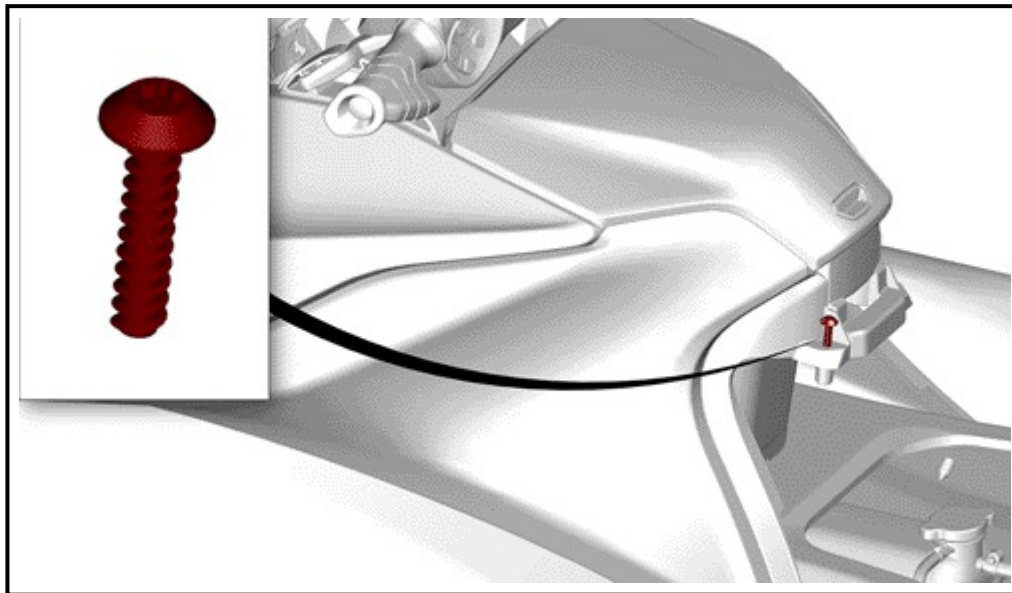

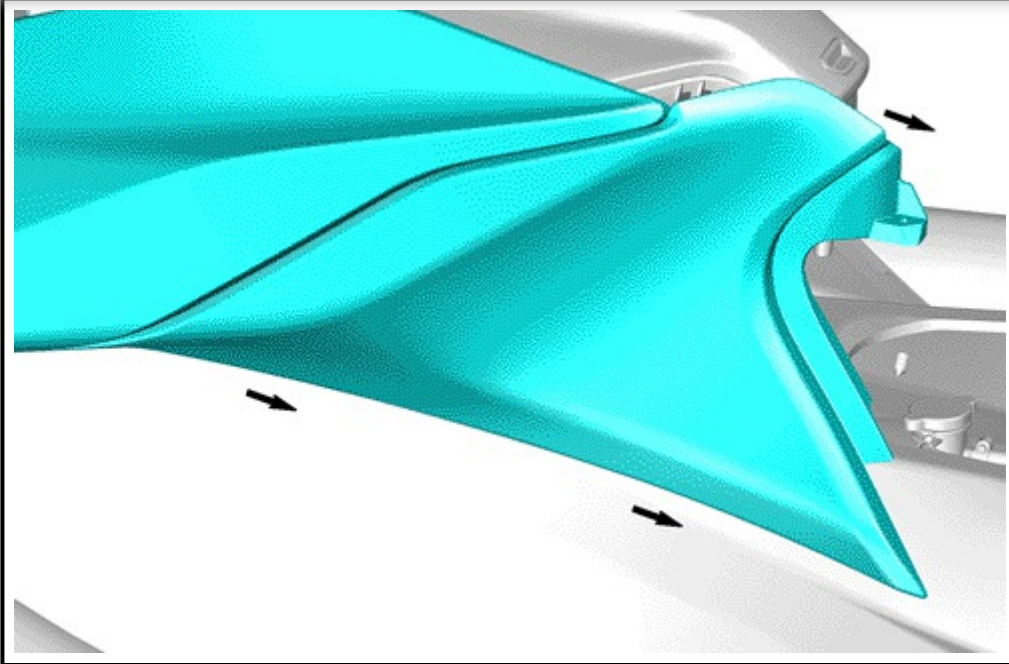

1.2 Disengage following tabs A and B.

1.3 Pull toward the rear to disengage both lateral trim panels.

1.4 Slide until all the darts C, D and E are disengaged.

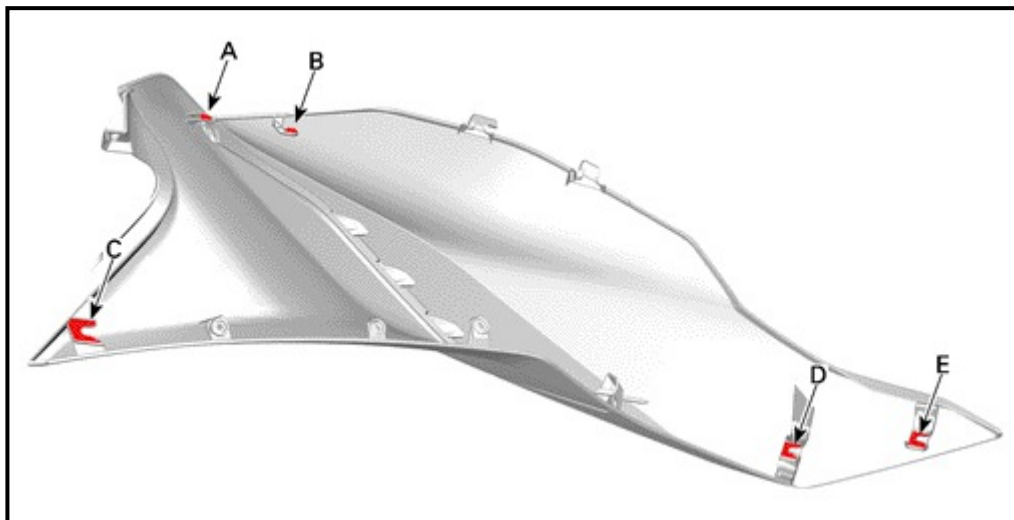

A and B are the tabs.

C, D and E are the sections where the darts insert into.

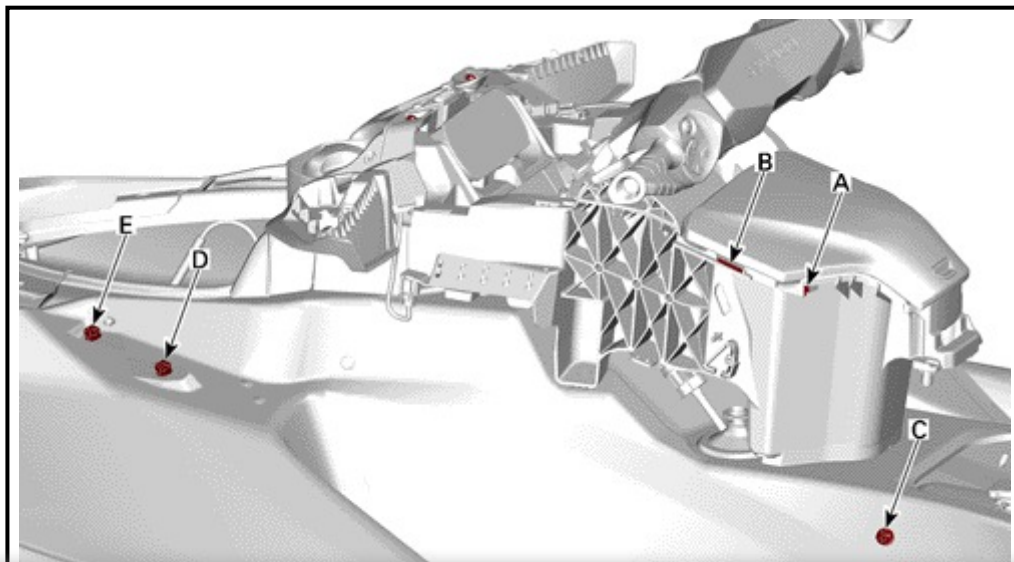

A and B are the tabs.

C, D and E are the darts .

Removing the Handlebar Grip

To remove handlebar grip, remove the cap, then the retaining screw and the washer. Keep fasteners for further installation step.

Pull out handlebar grip from handlebar and discard.

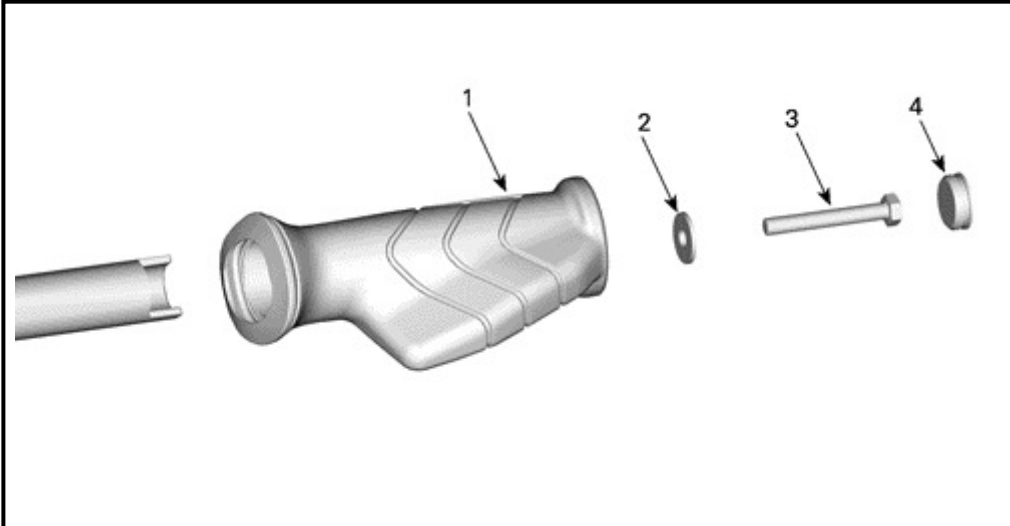

1. Handlebar grip
2. Handlebar grip screw
3. Handlebar grip cap

Removing the Handlebar Switch Cover (LH or RH)

1. Remove steering pad by pulling the bottom first and then the top.

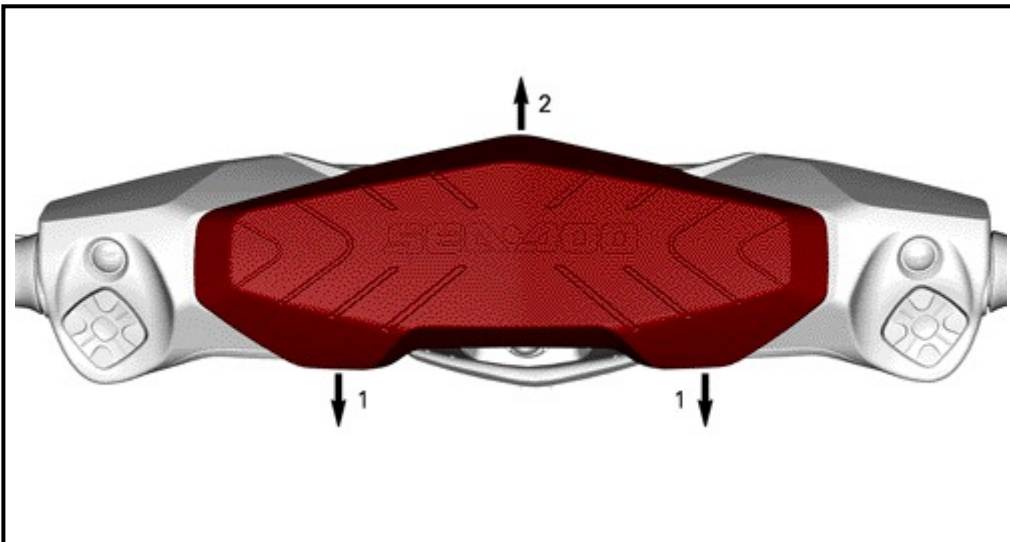

1. Bottom
2. Top

2. Remove the switch cover retaining screw.

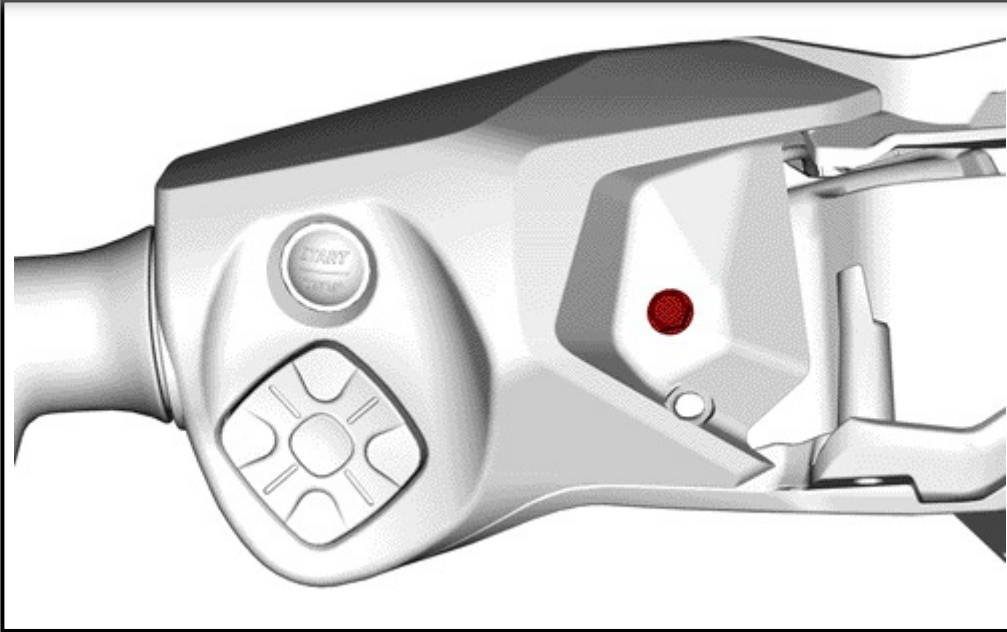

LH SIDE SHOWN

3. Remove the switch cover by lifting it from the bottom first.

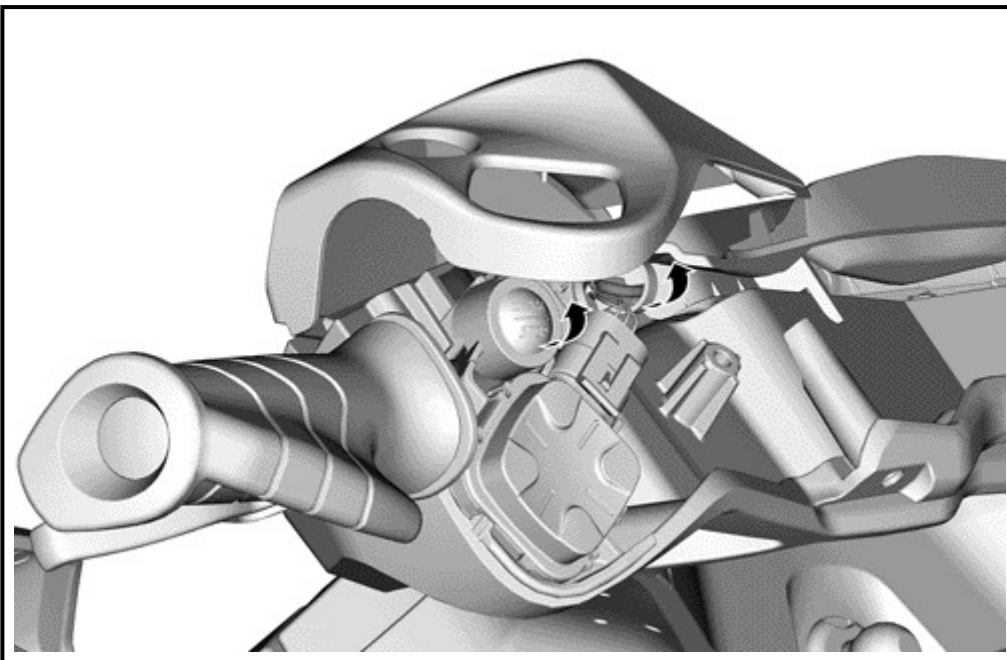

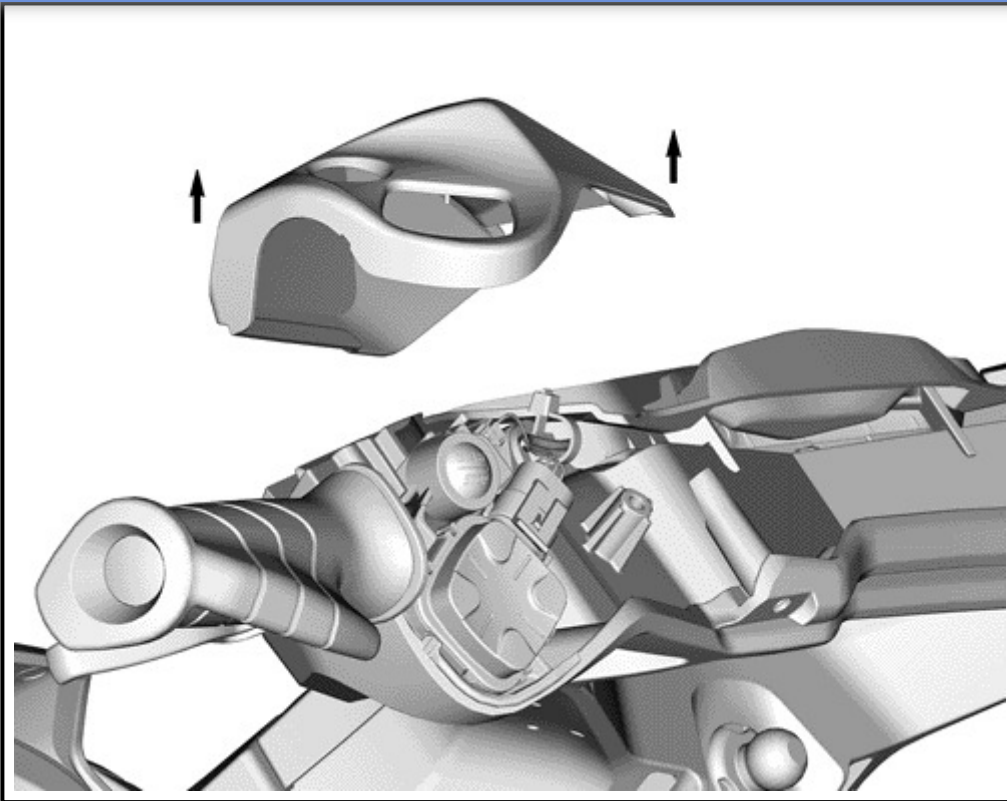

Removing the Steering Cover

1. Unlock steering cover from steering.

1.1 Insert a small tool, such as a small flat screwdriver, into a steering cover hole. Press the tool against the retaining tab to unlock it. Repeat for the other side.

NOTICE The tool must be inserted perfectly straight to avoid breaking the tab holder.

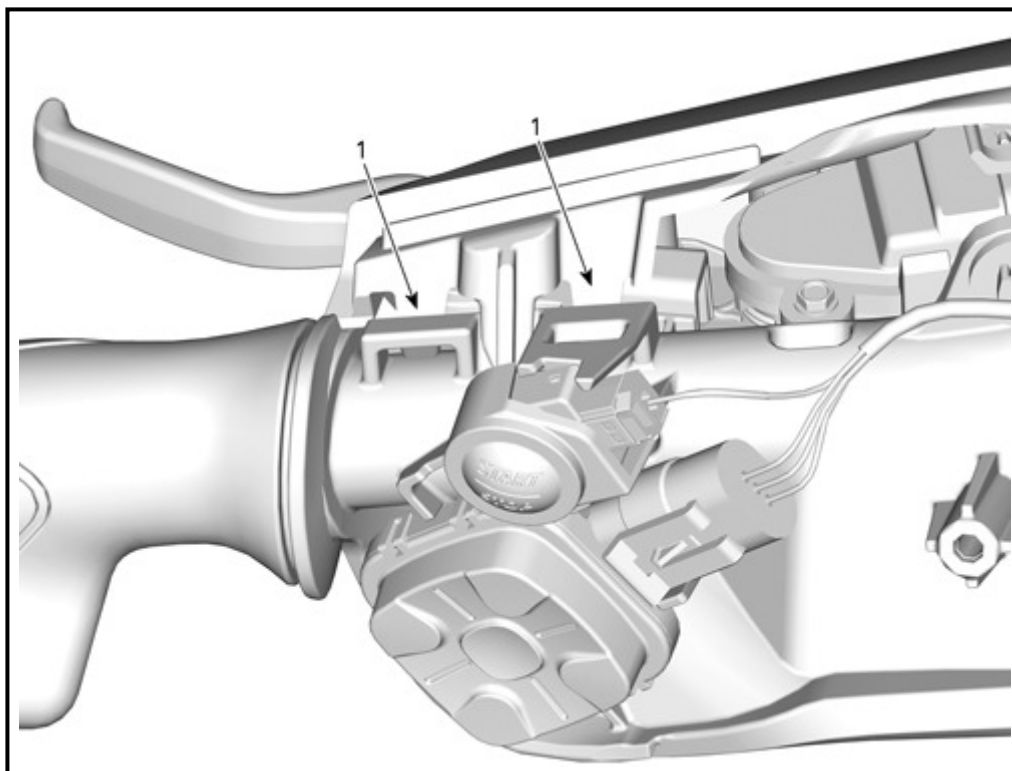

1. Retaining tab

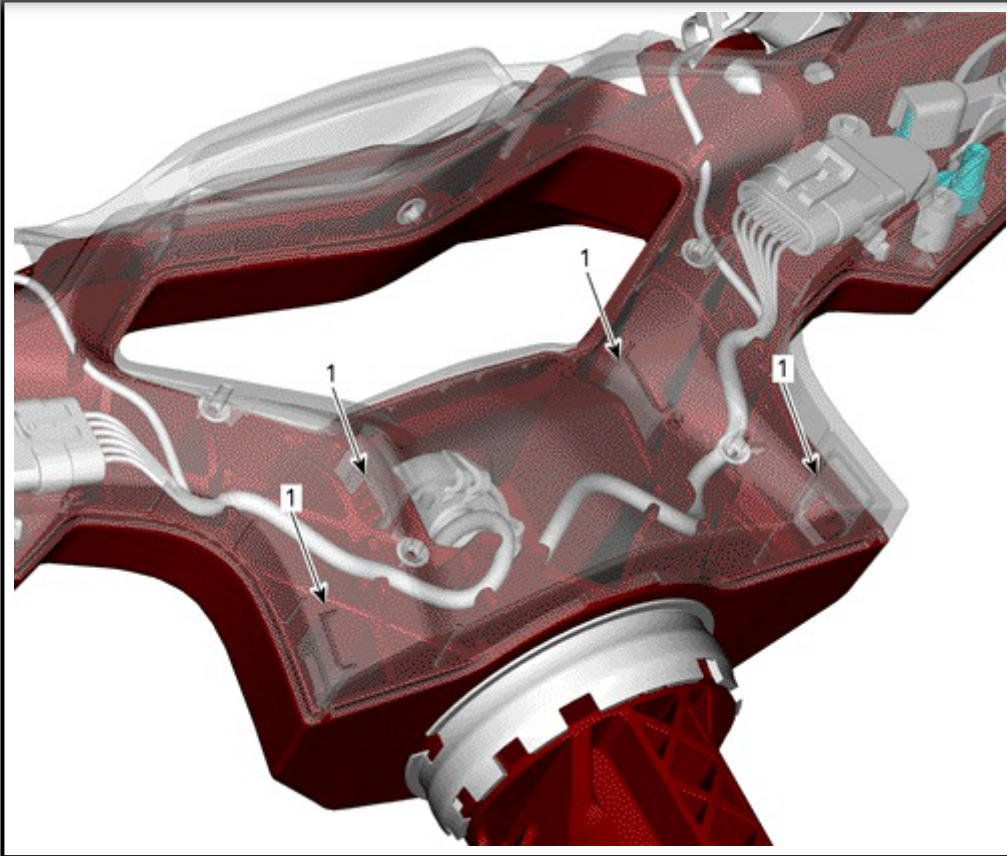

1. Retaining tab

1.2 In both cavities under the steering cover, release both inner retaining tabs using a long flat screwdriver.

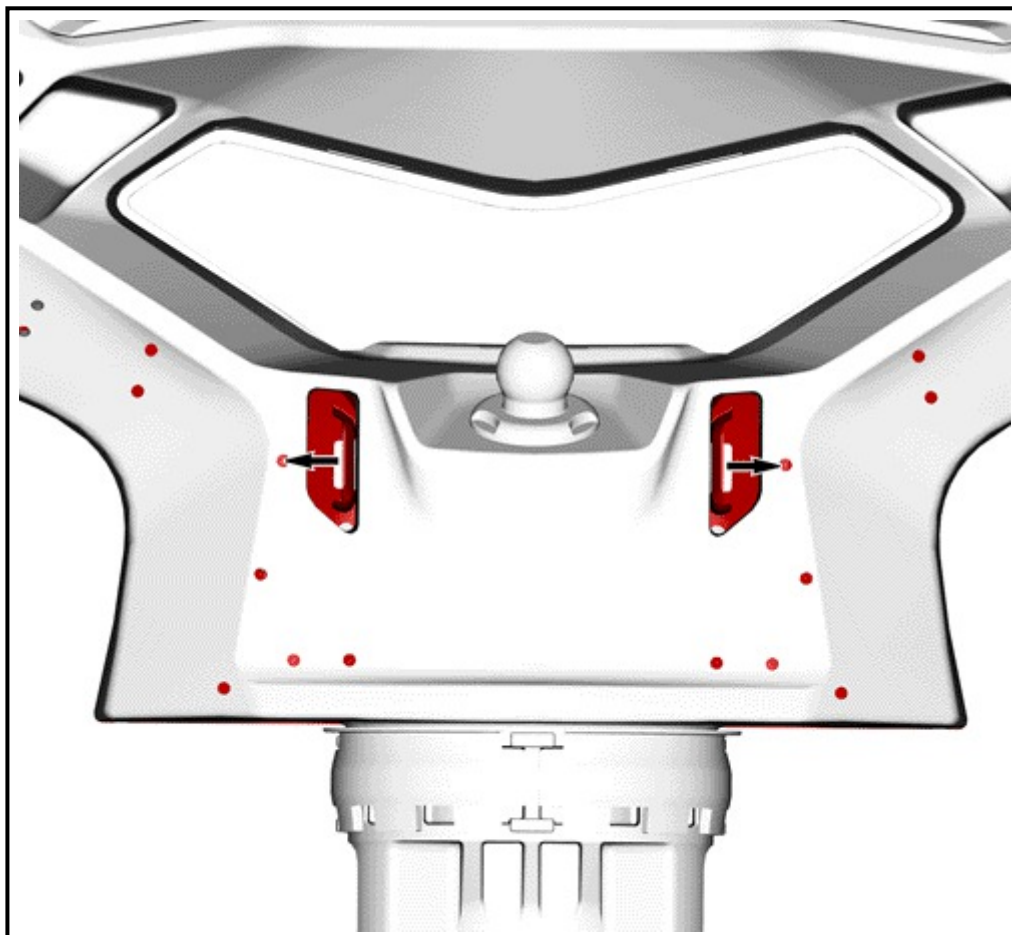

VIEWED FROM UNDERNEATH

1. Rear cavity

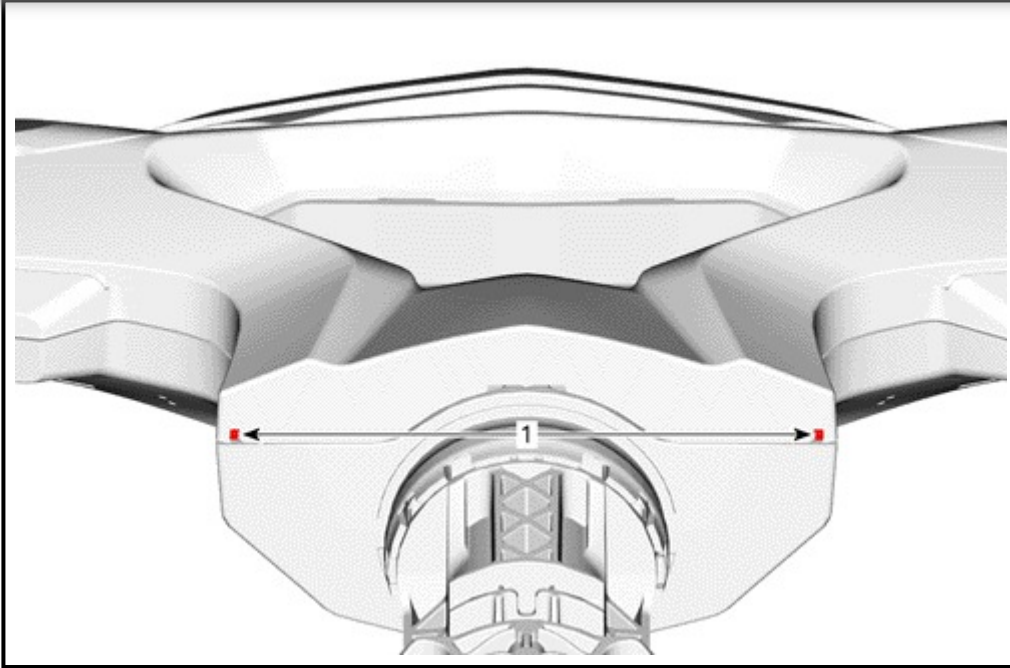

1. Tabs

2. Disconnect D.E.S.S. connector.

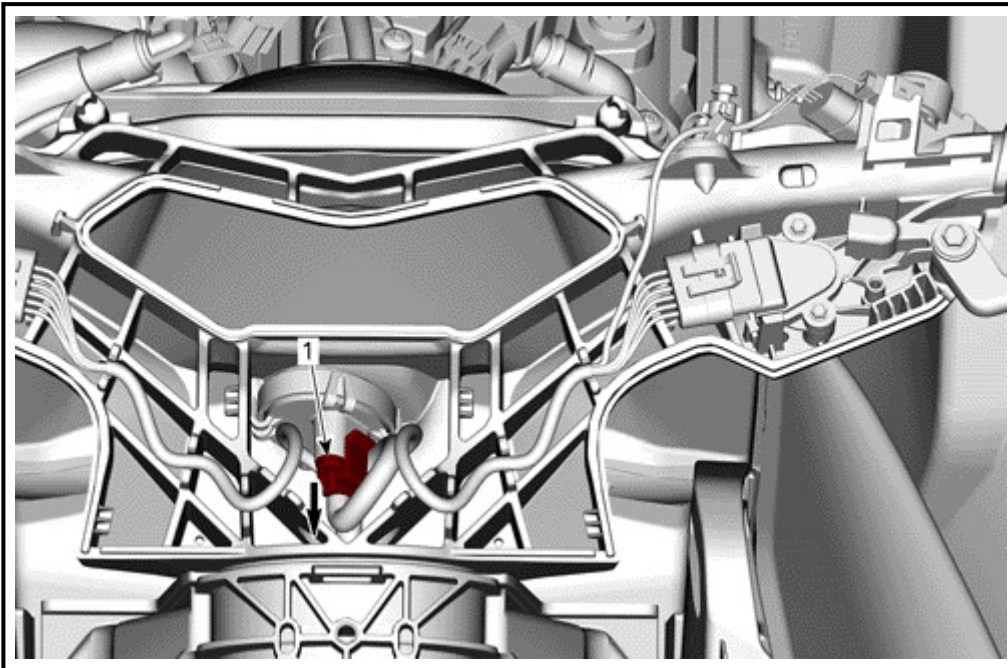

1. D.E.S.S. connector

Parts Installation

NOTICE When routing or installing harness ensure it does not contact any sharp edges, mobile parts and/or hot surfaces.

NOTE: Wiring Harness Extension (P/N 278003684) is required if a GPS, a Fish Finder or an audio kit is already installed.

1. Install heated grips [P1] and [P2] by matching it to the notch in the handlebar using kept fasteners. Apply threadlocker and tighten to specification.

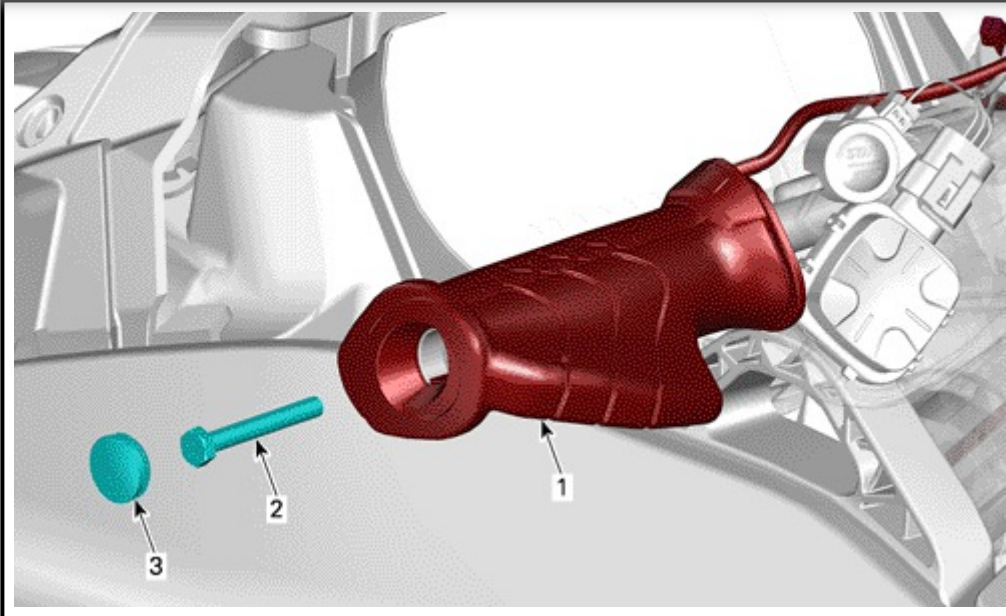

1. Grip
2. Screw
3. Cap

tightening torque

M6 Screw

$11 \pm 1 \text{ N}\cdot\text{m}$ ($97 \pm 9 \text{ lbf}\cdot\text{in}$)
+
LOCTITE 243 (BLUE) (P/N 293 800 060)

2. Route wires as shown below.

WARNING

- Make sure to secure wires in a way they cannot affect the levers and or steering functionality.

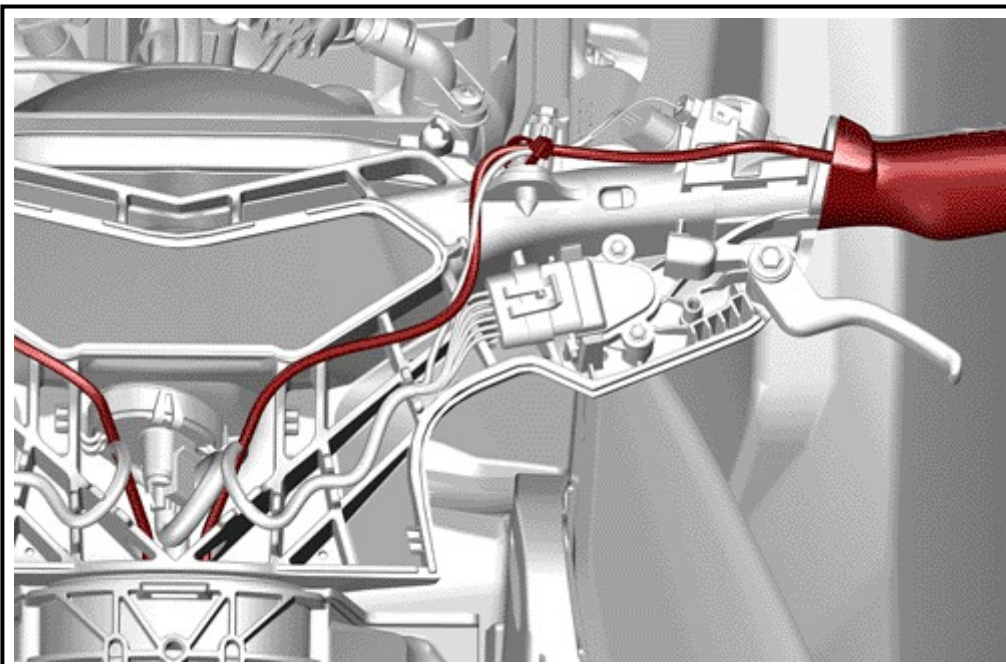

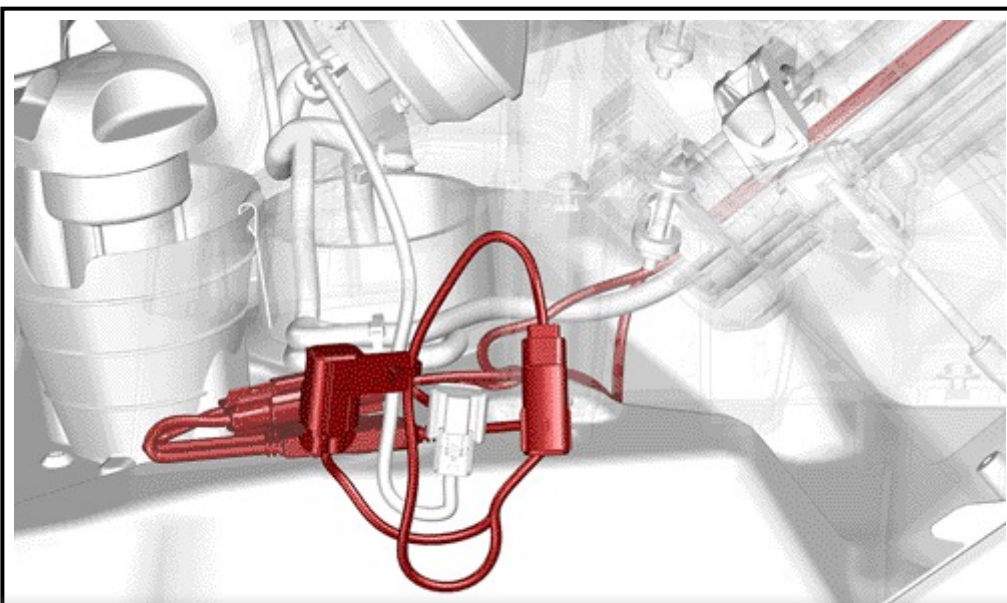
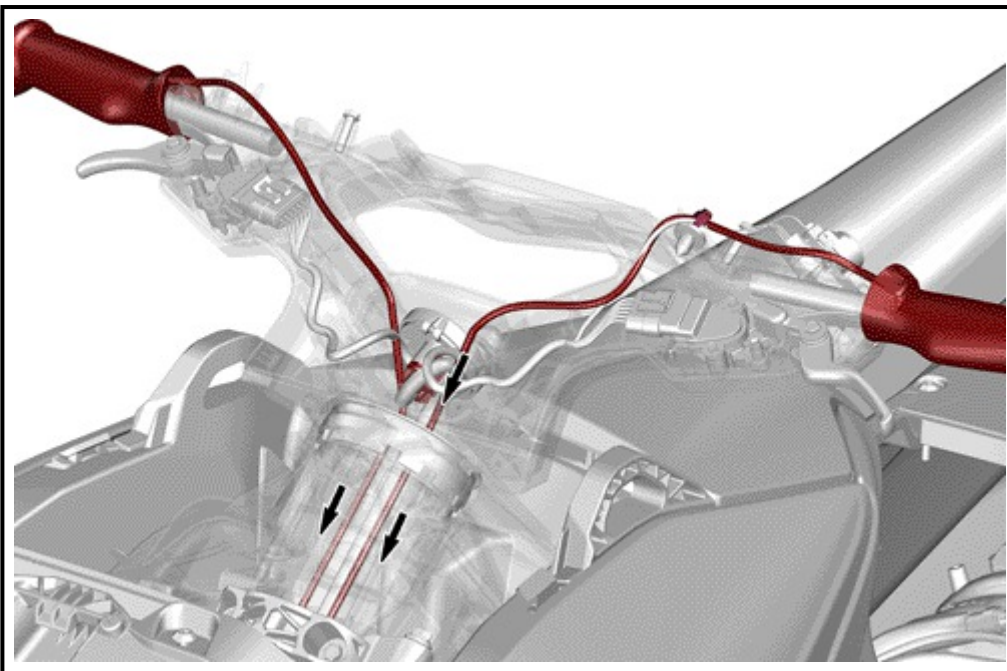
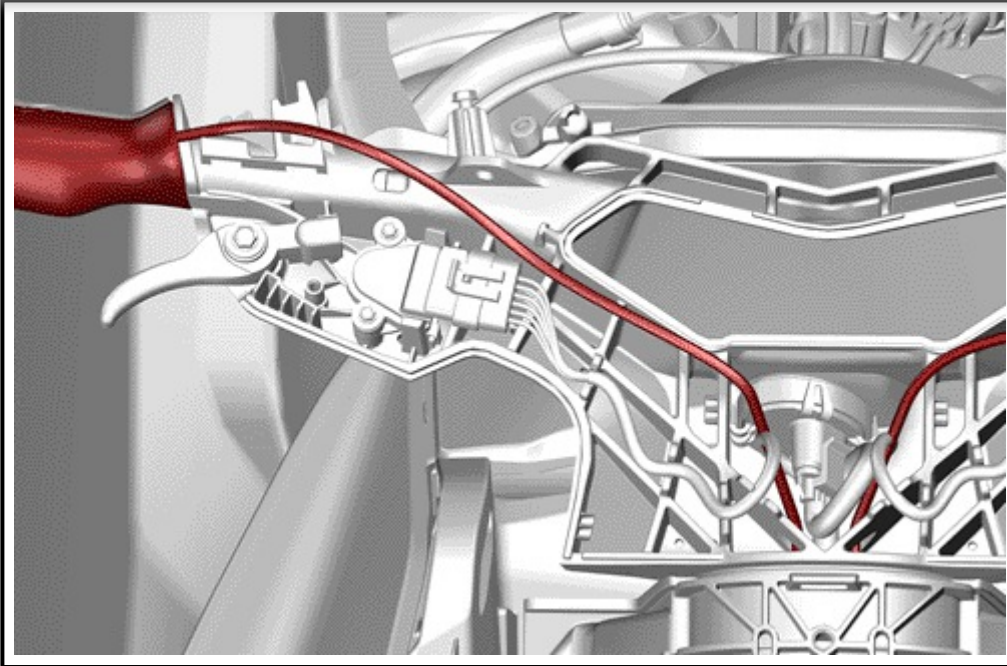

3. Connect heated grips harness [1] to main harness[2]. If the connector is already used, install Wiring harness extension . Refer to *EXTENSION HARNESS INSTALLATION*.

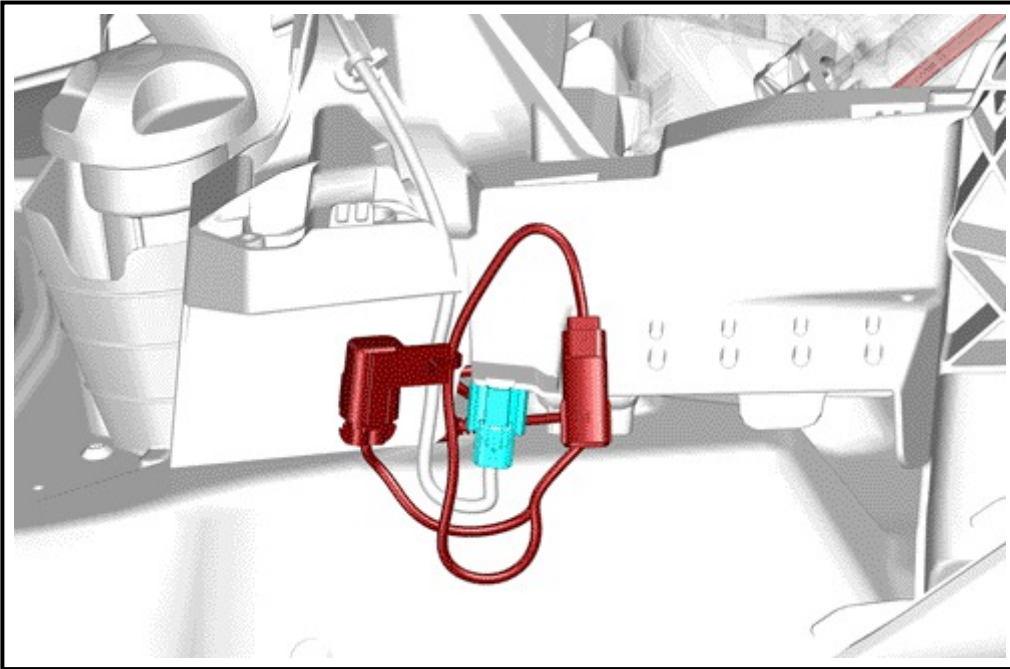

1. Heated grips harness connector
2. Main harness accessory connector

NOTICE Make sure to notch the covers as instructed below before reinstalling. The template provided is symmetric and should be used for both sides.

4. Notch the 2 covers to let pass the grips. Using a 5 mm (13/64 in) drill bit and the drilling templates, drill the 2 covers to let pass the grips wiring.

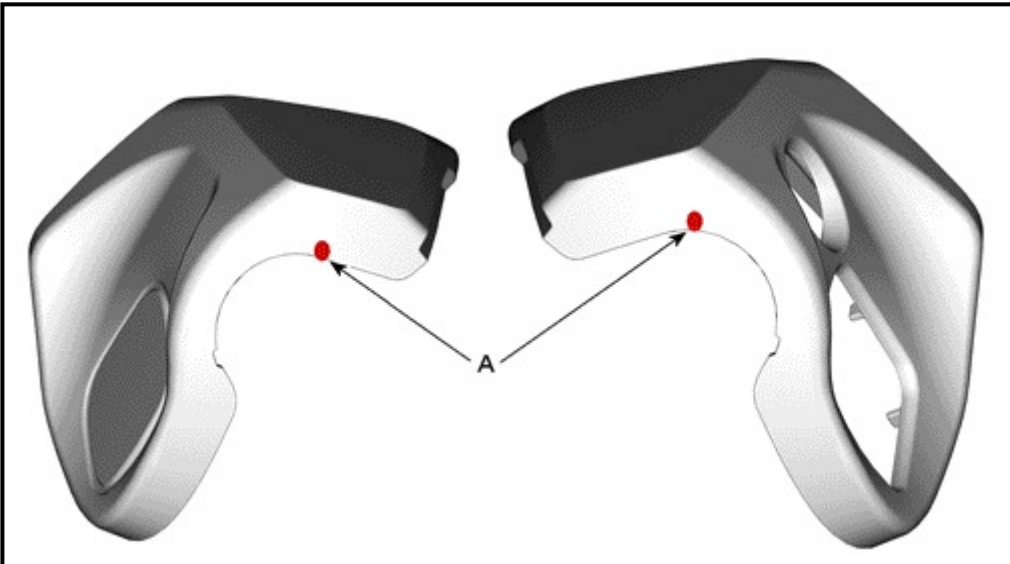

A. 5mm holes

5. Reconnect D.E.S.S. key module.
6. Reconnect the battery.

NOTICE Connect **RED** cable (+) first then **BLACK** cable (-).

7. Verify heated grips are functioning properly and reinstall all previously removed parts.

EXTENSION HARNESS INSTALLATION

1. If a GPS, a Fish Finder or an audio kit is already installed on unit, you will need to install Extension Harness 278003684 first which will allow you to connect a second accessory. ACC1 will connect to unit. ACC2 to the original already installed equipment and ACC3 to heated grips harness.

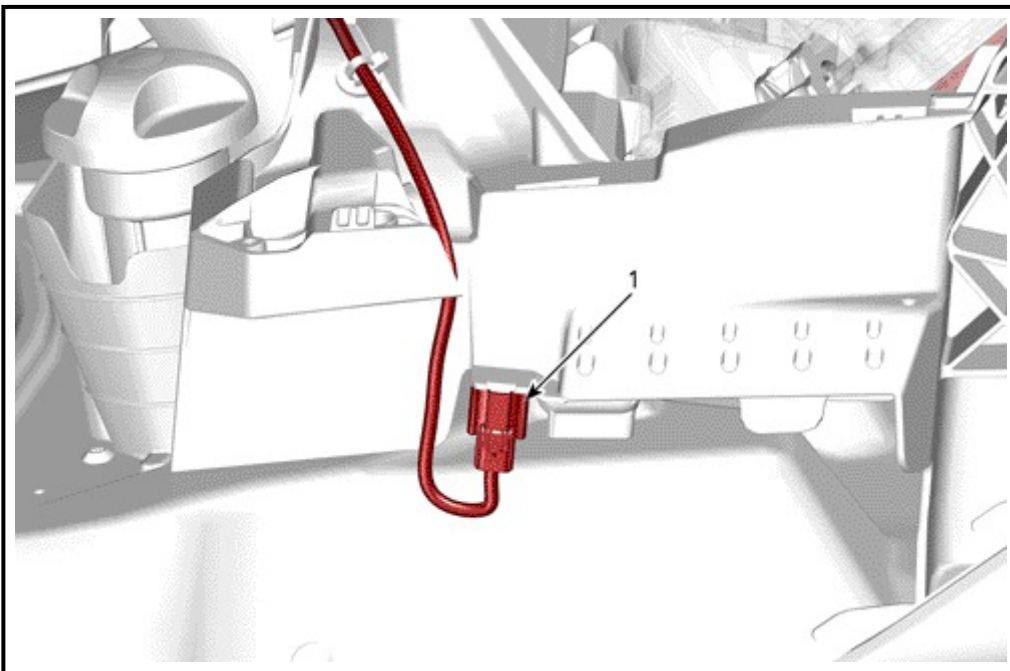
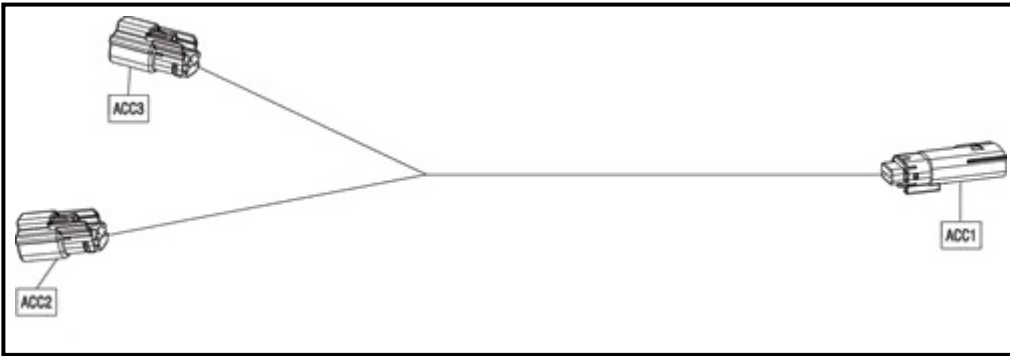

1. ACC1 to connect to unit

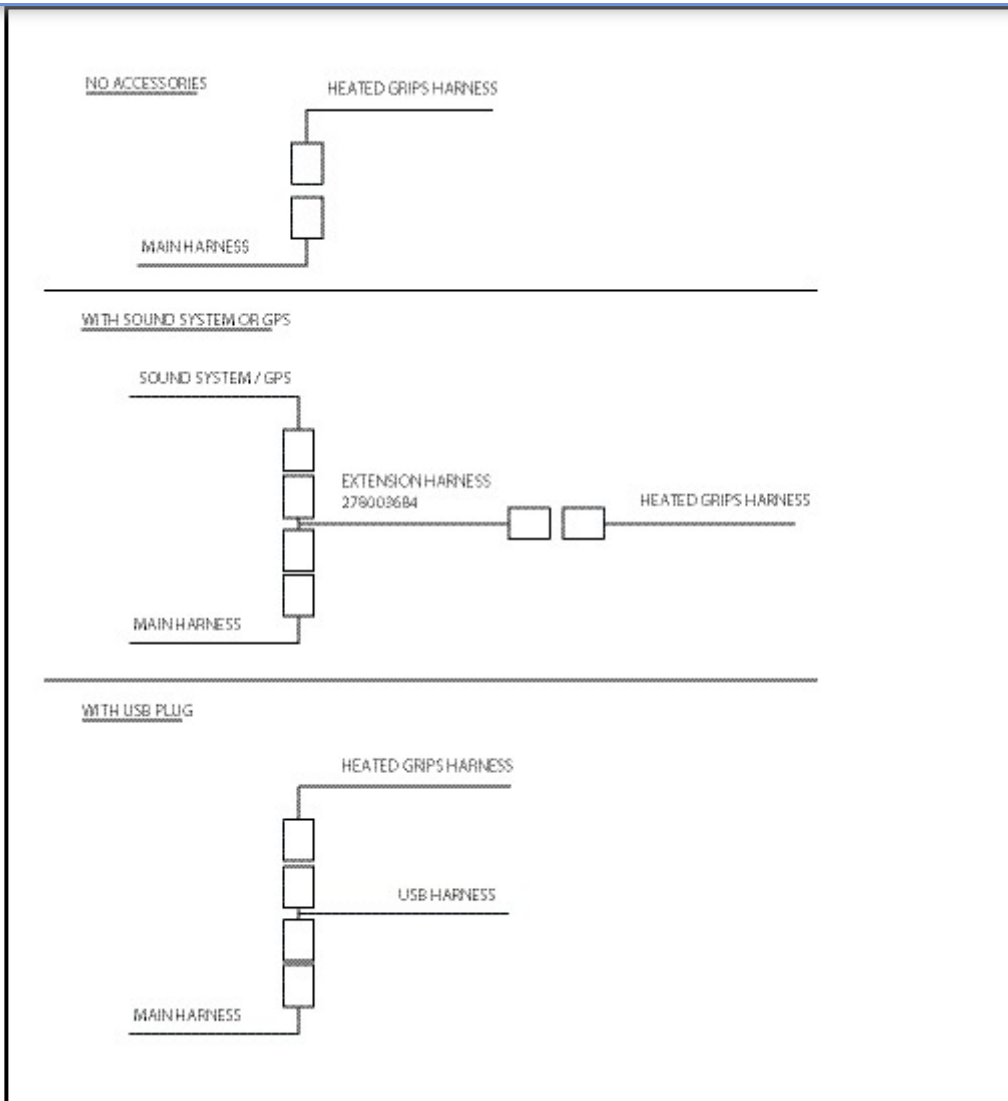

FUNCTION INSTRUCTIONS

1. Press and hold the button for 3 seconds to turn on the heated grips. Engine needs to be in function to make it work (see Low Battery section). A charger can also be installed on the battery to test it in the shop.

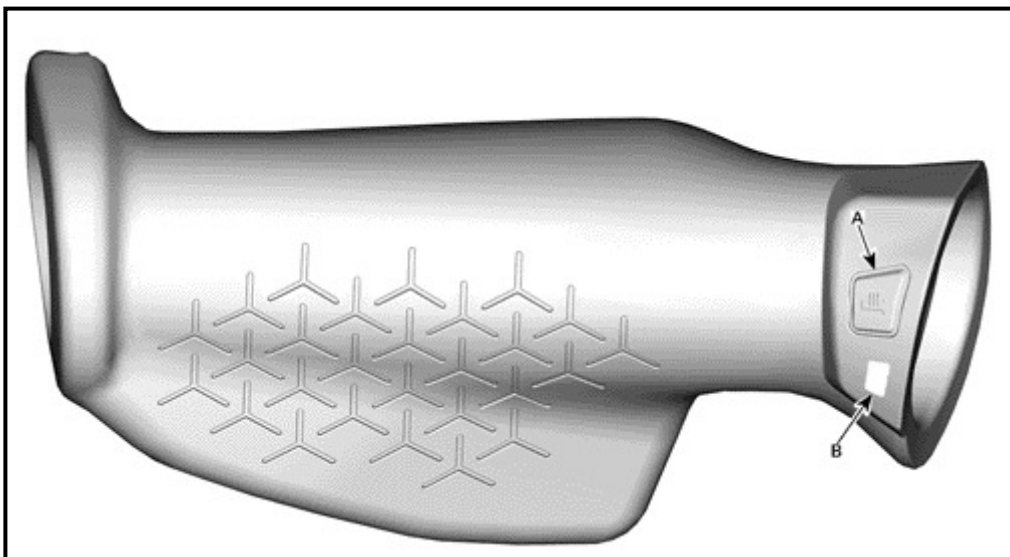

1. Set button
2. Light

NOTICE If the LED indicator does not light up, please check first if the heated grips are properly connected or if the fuse is not burned.

2. The heated grips are embedded with 5 heat levels.

Level	heating output	light color
Off / Low voltage	No heat / Engine is not running	Purple
1	20%	Blue
2	40%	Green
3	60%	Yellow
4	80%	Orange
5	100%	Red
Does not work	Defective heated grip	Flashing all colors

3. Press and hold the button for 3 seconds will shut off the heated grips at any level.

NOTICE LOW BATTERY

- If the voltage goes below 12,5V for more than 5 seconds, the heated grips will turn OFF automatically. It may also occur when the vehicle is not powered to protect from battery drainage when the vehicle is key on.
- The LED indicator will turn Purple and flash to indicate low voltage.

注：加熱されたグリップを復元/リセットするには：電圧が12.8Vを超えていることを確認してください。

[Template.pdf.pdf](#)

2099-02-12